

ADATTATORE
ADAPTOR

IP20

230 V
50-60 Hz

SPINA
PLUG



PRESA
SOCKET



1862Ⓢ

IND 3P 16A

Schuko Biv. 10/16A

10/150

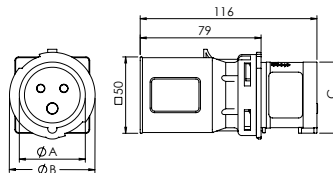

| | |
|-------|------|
| Amp | 16A |
| Poles | 3 |
| A | 43,2 |
| B | 56 |
| C | 46,5 |

ADATTATORE
ADAPTOR

IP20

230 V
50-60 Hz

400 V
50-60 Hz

SPINA
PLUG



PRESA
SOCKET



1872

IND 5P 16A 400V

Schuko Biv. 10/16A

10/150

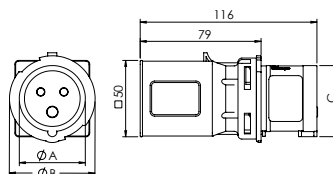

| | |
|-------|------|
| Amp | 16A |
| Poles | 5 |
| A | 56 |
| B | 68 |
| C | 60,5 |

ADATTATORE
ADAPTOR

IP20

230 V
50-60 Hz

SPINA
PLUG



PRESA
SOCKET



1864Ⓢ

IND 3P 16A

Biv. 10/16A (2x)

10/150

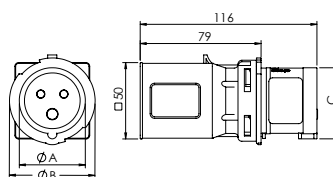

| | |
|-------|------|
| Amp | 16A |
| Poles | 3 |
| A | 43,2 |
| B | 56 |
| C | 46,5 |

ADATTATORE
ADAPTOR

IP20

230 V
50-60 Hz

400 V
50-60 Hz

SPINA
PLUG



PRESA
SOCKET



1873

IND 5P 16A 6h 400V

Biv. 10/16A (2x)

10/150

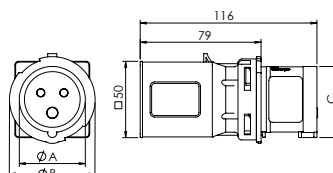

| | |
|-------|------|
| Amp | 16A |
| Poles | 5 |
| A | 56 |
| B | 68 |
| C | 60,5 |